

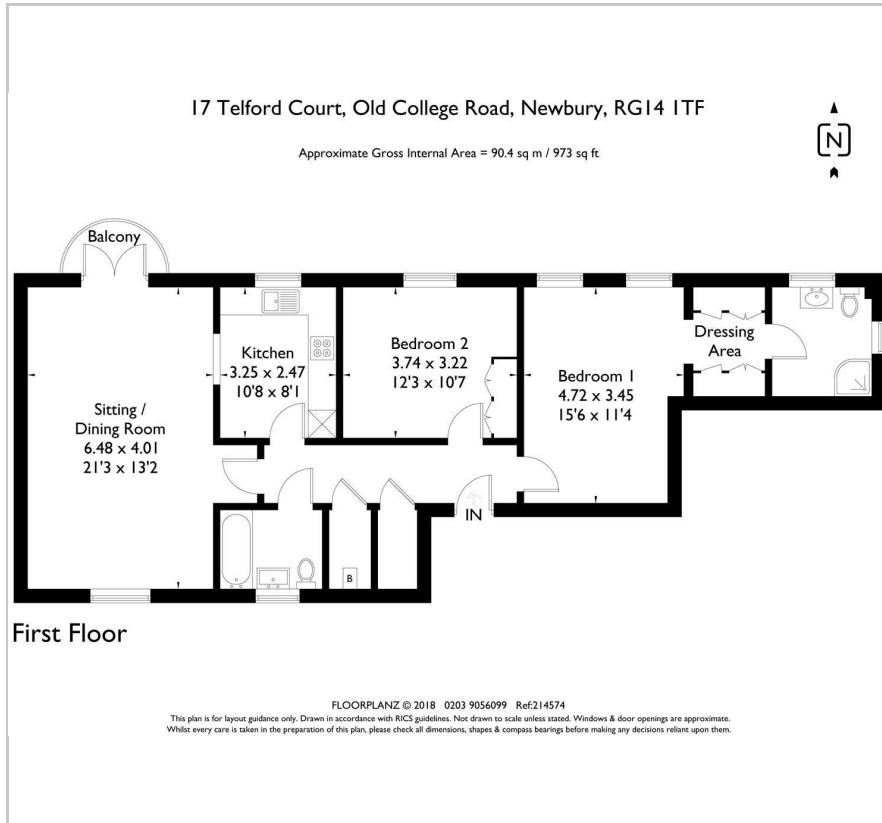

17 Telford Court
Old College Road, Newbury, RG14 1TF
£1,495 PCM



Floor Plan



Area Map

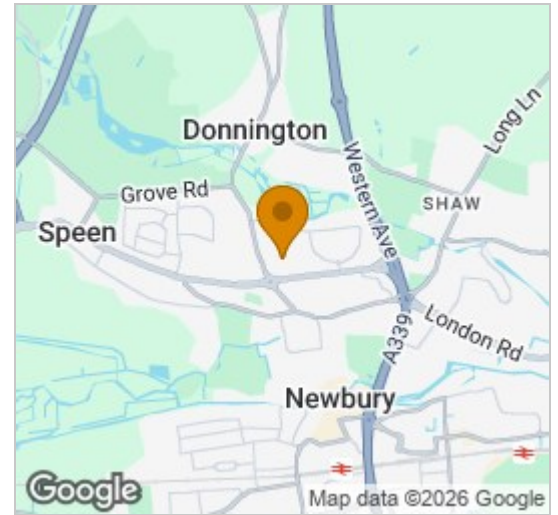

Energy Efficiency Graph

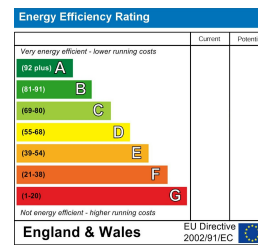

Viewing

Please contact our Girard Lettings Office on 01635 551911 if you wish to arrange a viewing appointment for this property or require further information.



An exceptionally spacious, elegant and light first floor executive style apartment with two double bedrooms and two bathrooms in the sought after College Mews development.

Conveniently placed within a few minutes walk to Newbury town centre and with excellent road links, the accommodation comprises: Smart communal entrance with lift and stairs, front door leading to spacious hallway with security entry phone system, dual aspect reception room with french doors and balcony overlooking small peaceful park, kitchen with white goods including dishwasher and fridge/freezer, large master bedroom with dressing area leading to en suite shower room, good sized second double bedroom with fitted wardrobes and family bathroom with shower over bath. The property benefits from underfloor heating throughout.

Outside there is one allocated parking space in a gated car park and visitors parking to the front of the building. The property is surrounded by well kept communal grounds.

DUE TO HEADLEASE NO PETS PERMITTED

AVAILABLE FROM BEGINNING OF AUGUST

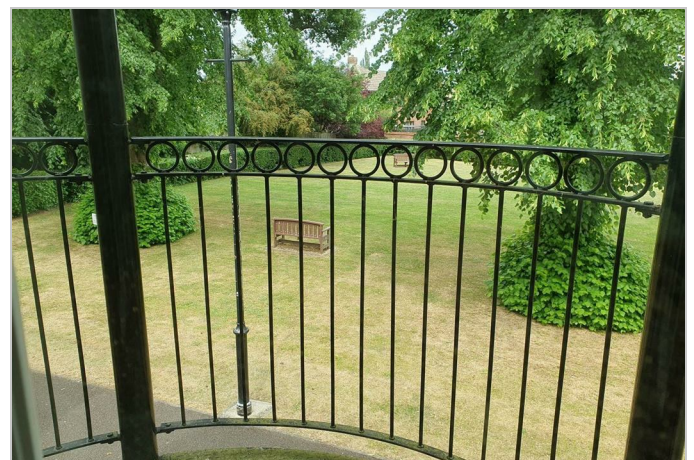

These particulars, whilst believed to be accurate are set out as a general outline only for guidance and do not constitute any part of an offer or contract. Intending purchasers should not rely on them as statements of representation of fact, but must satisfy themselves by inspection or otherwise as to their accuracy. No person in this firm's employment has the authority to make or give any representation or warranty in respect of the property.

The Gate House, 90 Bartholomew Street, Newbury, Berkshire, RG14 5DY
Tel: 01635 551911 Email: mail@girardlettings.co.uk www.girardlettings.co.uk